

# Ballymun Main Street, Ballymun, Ireland

This is a development framework for the Main Street in the north Dublin suburb of Ballymun.

The aim of the masterplan was to 'grow' Ballymun from a 1960's dormitory estate of high-rise social housing into a real town with new mixed tenure of homes, offices, shops, leisure and local government facilities for 30,000 people, with Main Street at its heart.

Our design involved changing the 1960's dual carriageway and cul de sacs into a major, tree-lined thoroughfare. New roads will link this boulevard to each of Ballymun's neighbourhoods, where new parks and local centres will help give each community an identity.

The development framework includes a new civic centre, arts centre and leisure centre. The symbolic demolition of the first tower allowed the new civic square to be laid out.

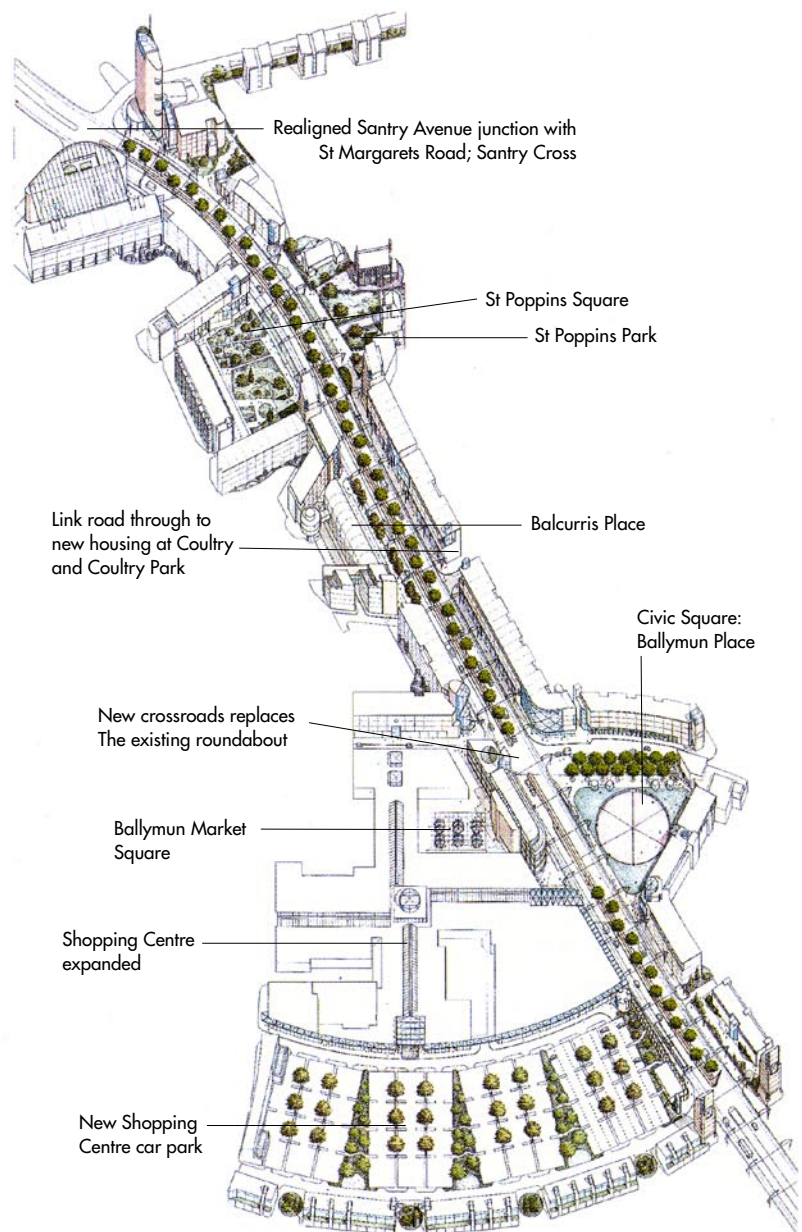

Proposed Main Street

The client team has delivered over 700 new homes and attracted major inward investment to Ballymun. Greater job opportunities, better transport links and new homes are all making Ballymun a good place to live. The team has also promoted 'Breaking Ground', an internationally known public art programme involving many artists and crafts people in Ballymun.



- 1    2    3
- 4

- 1 'Before' Aerial View of Ballymun Road
- 2 Drawing of proposed Main Street
- 3 Model of proposed Main Street
- 4 Public Consultation

Client: Ballymun Regeneration Limited  
 Completion: Ongoing