

Lancaster University Library

This project is an extension to the existing 1960's University library at Lancaster University.

In view of the uncertain future of libraries and evolving techniques of information retrieval and use, our building provides deep plan, flexible space to accommodate a wide spectrum of uses. Uses currently catered for include high density PC use, delivery of seminars, lectures and IT training, technology development, book and archive storage and exhibition,

reading and staff areas.

The raised floor contains all telecommunications and data cabling and acts as the air distribution plenum. The building is planned around a top-lit atrium, the location for noisier activities in the library. This arrangement frees the perimeter for quiet study. At either ends of the atrium are the archive area and the double-height Reading Room.



The double height reading room takes advantage of views to the horizon and Morecambe Bay

The Reading Room is a special place. Opening out towards the horizon, with a completely glazed western wall and brise soleil overlooking the entrance to the University, the Ruskin Library (also designed by MJP) and Morecambe Bay, it acts as a symbol for the library and the University – the 'locus of learning'.

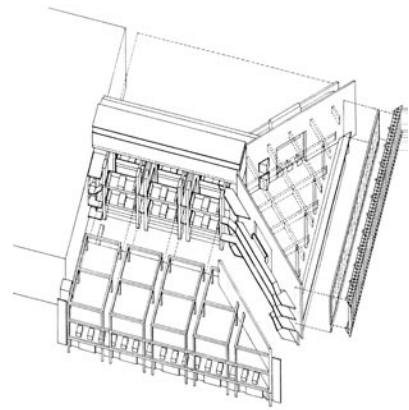

1
2 3
4

- 1 The axo shows how a second phase could be added if the library needs to expand
- 2 4 View of glazed western wall with brise soleil screen
- 3 The atrium provides a light and open focus to the library

Client Lancaster University
 Completion December 1996
 Cost £4m
 Contract Type JCT.80