

Burrells Field Trinity College, Cambridge

Our development for Trinity College lies to the west of the city centre in a spacious residential area, laid out at the end of the 19th century; and is linked to the main College buildings by the College gardens.

Four Edwardian houses and two modern student hostels already occupied the site, lying amongst fragments of the gardens belonging to the houses running down to Bin Brook, which flows into the River Cam. Our design clarified the site layout by using the new buildings to frame and

re-define the relationships between the existing buildings. It also creates a clear distinction between the open meadow along Bin Brook and the densely inhabited site.

The new buildings enclose the intensively landscaped site and control the access points for the development. They also overlook the principal external circulation routes to enhance security. The new accommodation is in the form of towers with staircase access to study bedrooms



Interlocking brick and steel framed glass 'cubes' give the accommodation a special identity

and Fellows' sets with en-suite showers and shared kitchens. Common rooms are built against the older hostels as a means of integrating the existing buildings into the new site layout.

Materials were carefully selected on the basis of the College's requirement to minimise future maintenance costs and are primarily brick and high quality precast concrete.

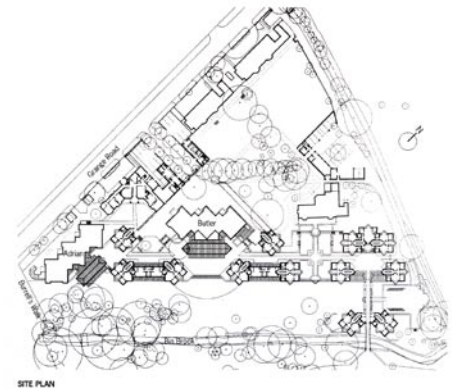

1
2
3

- 1 Site Plan
- 2 The new buildings create an escarpment up against an open meadow
- 3 The new buildings are arranged to enclose the perimeter of the site and enhance security

Client Trinity College, Cambridge
 Completion September 1995
 Contract Type JCT.1980